

DATA SHEET

T 4.25 DSK

ROTARY VANE PRESSURE/VACUUM PUMPS

oil-free and air-cooled
with compressed air cooler

MAKE IT BECKER.



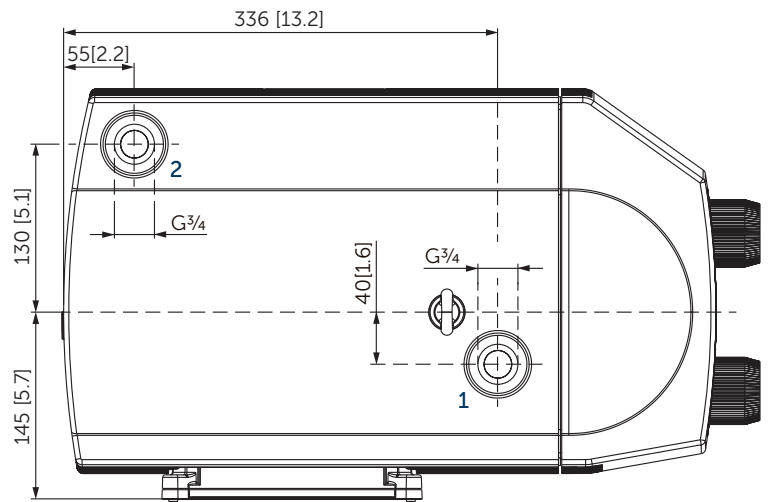
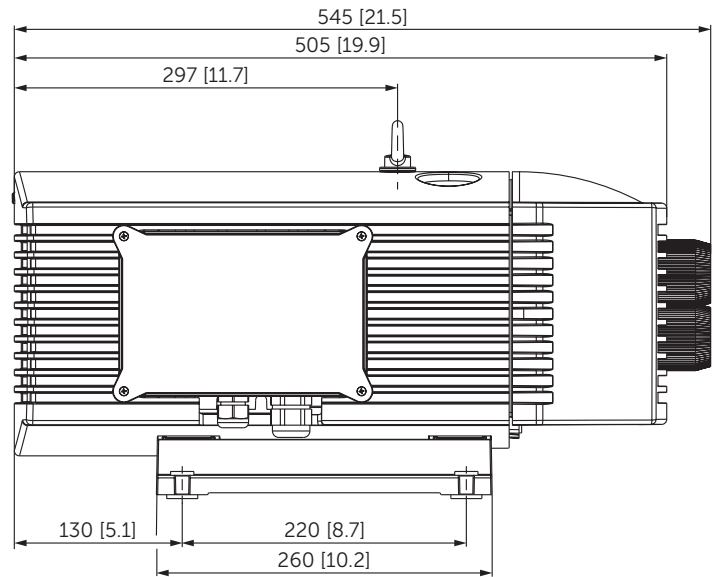
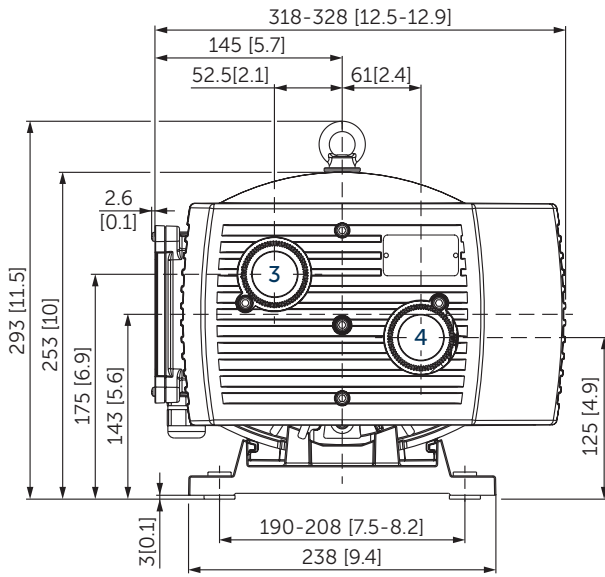

- 1 Vacuum connection (G^{3/4})
- 2 Pressure connection (G^{3/4})
- 3 Vacuum regulating valve
- 4 Pressure regulating valve
- Including integrated suction air filter and compressed air cooler
- The illustration of the terminal box may vary.
- Dimensions in mm [inch]

| Air rate | | Pressure/vacuum relative | | Emission sound pressure level ¹⁾ | | Weight with motor ²⁾ |
|-------------------|-------|--------------------------|-------|---|-------|---------------------------------|
| m ³ /h | | bar | | dB(A) | | kg |
| 50 Hz | 60 Hz | 50 Hz | 60 Hz | 50 Hz | 60 Hz | |
| 25 | 30 | ±0.6 | ±0.6 | 69 | 69 | ≈35–49.5 |

¹⁾ According to DIN EN ISO 3744 (KpA = 3 dB(A)), 1 m [39.4 inch] distance, at medium load, both connection sides piped

²⁾ Depending on the motor

| 3~ Motors | | | | | | | | | | | |
|-----------|-------|---------------------|-----|------|---------------------|------------|---------------------|------|---------|--|------------------------|
| # | 50 Hz | | | | | 60 Hz | | | | | Version |
| | kW | V | rpm | A | kW | V | rpm | A | | | |
| 01 | 1.1 | Y400 | IE3 | 1140 | 2.6 | YY230/Y460 | IE3 | 1735 | 5.0/2.5 | UL (E113150) • CC046A IP55 • ISO F PTO bimetal 150°C | |
| | | | | | | YY208 | IE3 | 1730 | 5.4 | | |
| | | | | | | Y400 | | 1725 | 2.7 | | |
| 02 | 1.1 | 190–255/ 330–440 | | 1420 | 4.8–5.5/ 2.8–3.2 | 1.3 | 190–290/ 330–500 | | 1690 | 6.2–4.9/ 3.6–2.8 | IP54 • ISO F • bimetal |

| 1~ Motor | | | | | | | | | | | |
|----------|-------|----------|------|-----|----|-------|---------|---|------|----------|------------------------------------|
| # | 50 Hz | | | | | 60 Hz | | | | | Version |
| | kW | V | rpm | A | kW | V | rpm | A | | | |
| 01 | 1.1 | 230 ±10% | 1350 | 7.6 | | | | | | | IP54 • ISO F • bimetal |
| 02 | | | | | | 1.3 | 220–240 | | 1740 | 8.6–8.35 | UL • CSA IP54 • ISO F • bimetal |

- Current consumption and rotation speed may vary. Tolerance in each case -1.5/+2%

| Air rates • power consumptions • temperatures | | | | | | | | | | |
|---|----------------------------|-------------------|-----------------|----------|----------|----------|-------|----------|----------|----------|
| relative pressure | | | relative vacuum | | | | | | | |
| | | | 50 Hz | | | | 60 Hz | | | |
| | | | 0 bar | -0.4 bar | -0.5 bar | -0.6 bar | 0 bar | -0.4 bar | -0.5 bar | -0.6 bar |
| +0.4 bar | Suction air rate | m ³ /h | 23.8 | 12.7 | 10 | 7.2 | 28.6 | 15.55 | 12.3 | 9.08 |
| | Blast air rate | m ³ /h | 25.3 | 20 | 18.6 | 17.3 | 30.8 | 23.4 | 21.6 | 19.7 |
| | Power consumption | kW | 0.71 | 0.91 | 0.96 | 1 | 0.95 | 1.1 | 1.14 | 1.18 |
| | Temperature compressed air | °C | 35 | 37 | 38 | 38 | 37 | 40 | 41 | 42 |
| +0.5 bar | Suction air rate | m ³ /h | 23.4 | 12.5 | 9.9 | 7.1 | 28.5 | 15.5 | 12.25 | 9.05 |
| | Blast air rate | m ³ /h | 24.9 | 19.6 | 18.2 | 16.9 | 30.65 | 23.3 | 21.5 | 19.6 |
| | Power consumption | kW | 0.75 | 0.95 | 1 | 1.05 | 1.02 | 1.16 | 1.2 | 1.24 |
| | Temperature compressed air | °C | 36 | 38 | 39 | 39 | 38 | 41 | 42 | 43 |
| +0.6 bar | Suction air rate | m ³ /h | 23 | 12.3 | 9.7 | 7 | 28.3 | 15.4 | 12.2 | 9 |
| | Blast air rate | m ³ /h | 24.5 | 19.2 | 17.8 | 16.5 | 30.5 | 23.1 | 21.3 | 19.4 |
| | Power consumption | kW | 0.8 | 1 | 1.05 | 1.1 | 1.07 | 1.22 | 1.26 | 1.3 |
| | Temperature compressed air | °C | 37 | 39 | 40 | 40 | 39 | 42 | 43 | 44 |

Reference data (atmosphere): 1000 mbar (100 kPa), 20°C (68°F)

Tolerance: ±5%

Air temperature: 5°C ... 45°C (41°F ... 135°F)

+ VARIANTS AND ACCESSORIES

- **T 4.25 DV** without compressed air cooler, maximum ± 0.5 bar, lower motor power and overall dimensions¹⁾
- With external suction filter¹⁾
- Sound proof box SH 19¹⁾



Example for an external suction filter



Sound proof box SH 19

¹⁾ See separate data sheet

- Possible combinations on request



MAKE IT BECKER.